

Braga 45°

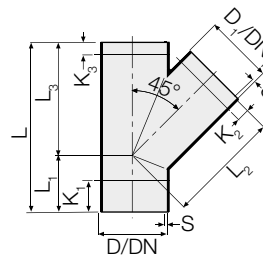

COD.	D/D ₁	DN/DN ₁	S/S ₁	L	L ₁	L ₂ /L ₃	K ₁	K ₂	K ₃	kg				HxLxP	CL	€/pz
VS0309001	32	30	3	110	35	75	20	20	20	0,044	50	400	2400	1060x800x1200	PE02	4,58
VS0309003	40	40	3	135	45	90	25	30	30	0,069	50	400	2000	1180x800x1200	PE02	4,88
VS0309005	50	50	3	165	55	110	35	20	20	0,105	20	160	960	1180x800x1200	PE02	5,36
VS0309006	56	56	3	180	60	120	40	25	25	0,124	20	160	800	1180x800x1200	PE02	6,47
VS0309007	63	60	3	195	65	130	40	25	25	0,151	15	120	600	1180x800x1200	PE02	7,21
VS0309009	75	70	3	210	70	140	40	25	25	0,190	20	80	320	1050x800x1200	PE02	8,32
VS0309011	90	90	3,5	240	80	160	50	20	20	0,312	15	60	240	1210x800x1200	PE02	10,83
VS0309013	110	100	4,3	270	90	180	55	20	20	0,491	10	40	120	1054x800x1200	PE02	13,56
VS0309015	125	125	4,9	300	100	200	60	20	20	0,773	10	40	80	950x800x1200	PE02	16,15
VS0309017	160	150	6,2	375	125	250	75	25	25	1,479	1	-	45	930x800x1200	PE02	62,12
VS0309019 *	200	200	6,2	540	180	360	85	10	10	2,811	1	-	16	930x800x1200	PE02	148,53
VS0309021 *	250	250	7,8	660	220	440	115	55	55	5,166	1	-	8	930x800x1200	PE02	231,44
VS0309023 *	315	300	9,8	840	280	560	160	95	95	10,254	1	-	3	930x800x1200	PE02	310,59

* Derivazione saldata.

Braga 45° con ispezione D 63

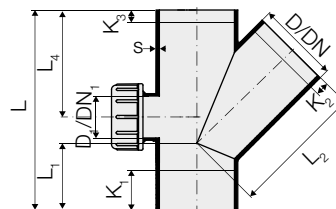

COD.	D/D ₁	DN/DN ₁	s	L	L ₁	L ₂ /L ₃	L ₄	K ₁	K ₂	K ₃	kg		CL	€/pz
VS0309991	110/63	100/60	4,3	270	90	180	145	55	20	20	0,605	1	PE02	36,40

Derivazione saldata.