

## GAMMA HDPE

### Braga 88°30' con ispezione D 63

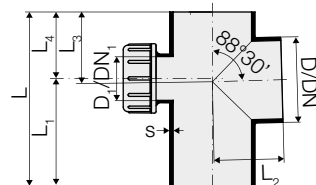

COD.	D/D <sub>1</sub>	DN/DN <sub>1</sub>	s	L	L <sub>1</sub>	L <sub>2</sub> /L <sub>3</sub>	L <sub>4</sub>	K <sub>1</sub>	K <sub>2</sub>	K <sub>3</sub>	kg		CL	€/pz
VS0312991	110/63	100/60	4,3	225	135	90	86	65	20	20	0,464	1	PE02	39,48

Derivazione saldata.

### Braga ad angolo 88°30'

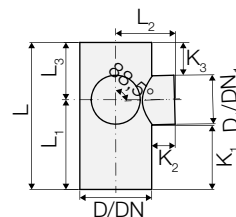

COD.	D <sub>1</sub> /D <sub>2</sub> /D <sub>3</sub>	DN <sub>1</sub> /DN <sub>2</sub> /DN <sub>3</sub>	L	L <sub>1</sub>	L <sub>2</sub> /L <sub>3</sub>	K <sub>1</sub>	K <sub>2</sub>	K <sub>3</sub>	kg		CL	€/pz
VS0310973	75/50/50	70/50/50	175	105	70	70	25	35	0,157	1	PE02	26,56
VS0310981	110/50/50	100/50/50	225	135	90	95	25	50	0,359	1	PE02	27,62
VS0310982	110/63/63	100/60/60	225	135	90	70	25	45	0,355	1	PE02	29,21
VS0310983	110/75/75	100/70/70	225	135	90	85	25	35	0,356	1	PE02	34,57
VS0310985	110/110/100	100/100/100	225	135	90	65	20	20	0,434	1	PE02	77,81
VS0310987	160/110/110	150/100/100	350	210	140	135	45	60	1,165	1	PE02	85,11

Derivazione saldata.

### Braga doppia 45°

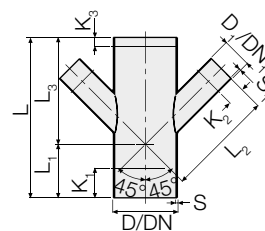

COD.	D/D <sub>1</sub>	DN/DN <sub>1</sub>	S	S <sub>1</sub>	L	L <sub>1</sub>	L <sub>2</sub> /L <sub>3</sub>	K <sub>1</sub>	K <sub>2</sub>	K <sub>3</sub>	kg				HxLxP	CL	€/pz
VS0314001	110/40	100/40	4,3	3	270	90	180	95	30	15	0,430	10	40	120	1054x800x1200	PE02	29,58
VS0314003	110/50	100/50	4,3	3	270	90	180	95	30	15	0,452	10	40	120	1054x800x1200	PE02	29,58
VS0314005	110/110	100/100	4,3	4,3	270	90	180	50	15	15	0,615	5	20	60	1054x800x1200	PE02	29,58